



CAMS

Capitol Accessibility, Maintenance and Safety

September 2016

LEGISLATIVE ADMINISTRATION

Accessibility

- Interior doors
- Bathroom stalls
- Accessible entrance/exit at primary building entries

Maintenance

- Exterior weatherproofing
- Windows
- Roofing and skylights
- Heating, ventilation and cooling (HVAC)
- Electrical service
- Restroom piping
- Rotunda plaster and mural repairs
- Misc building systems (elevators, etc)

Safety

- Emergency generator
- Exiting from upper floors
- State Police re-location
- Fire detection at Governor's suite

Accessibility

The Oregon State Capitol should be accessible for Oregonians of all physical abilities to participate in the legislative process.



Accessibility



- Replace knobs with levers on interior doors, while maintaining historic character.
- Lower door thresholds to minimize tripping hazards and improve wheelchair access.
- Update bathroom stall hardware to meet ADA standards.



Accessibility



- Create accessible entries at the front of the building, while keeping the historic revolving doors intact.
- Improve accessible exiting at the east and west sides of the building.
- Make the State Street entry accessible by adding ramps.

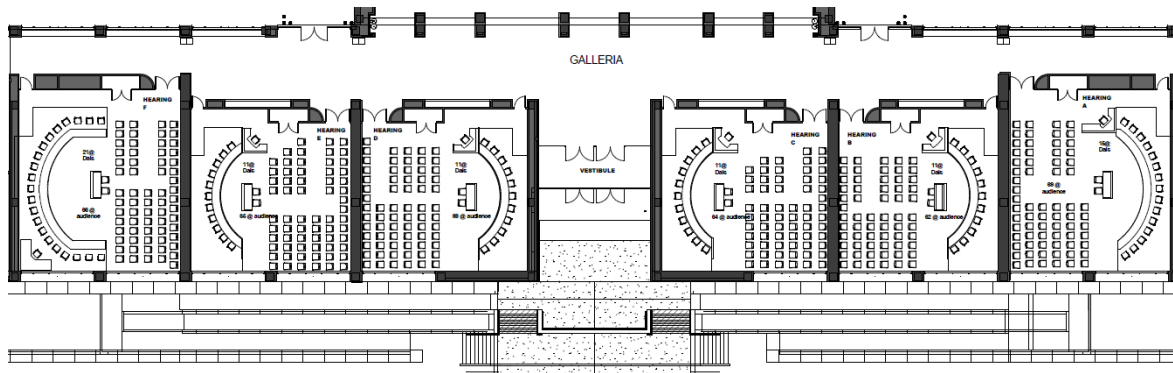

Maintenance

The Oregon State Capitol building should function efficiently, while providing a healthy and comfortable environment for occupants and visitors.



AP Photo/Chris Wedel



Maintenance



- Replace failing cooling towers.
- Replace steam heating system with hot water boilers, for better safety and efficiency.
- Repair or replace parts of the ventilation system as needed.



Maintenance



- Re-route main electrical feed from unsafe vault and replace failing electrical switchgear.
- Modernize building systems at end-of-life (elevator controls, etc).
- Repair failing piping in restrooms.



Maintenance



- Re-seal exterior marble and exterior of windows at the 1938 section. Fix broken window panes and window operability issues.
- Repair roof membrane and replace failing skylights.
- Repair flaking plaster and murals at the Rotunda.



Safety

As a significant place of assembly, the Oregon State Capitol building should provide enhanced fire and life safety, and be supportive of security operations.

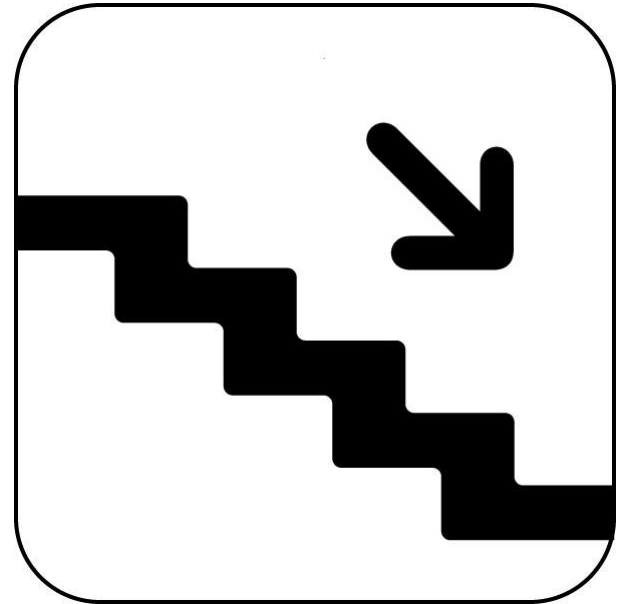

Safety



- Install new emergency generator with expanded capacity, and in-ground fuel tank for the generator.
- Re-locate Oregon State Police to location on first floor with better access to high-traffic areas.



- Repair failed fire detection system at the Governor's ceremonial office.
- Create new stairwells at north (Court Street) entry, to improve exiting from upper floors.

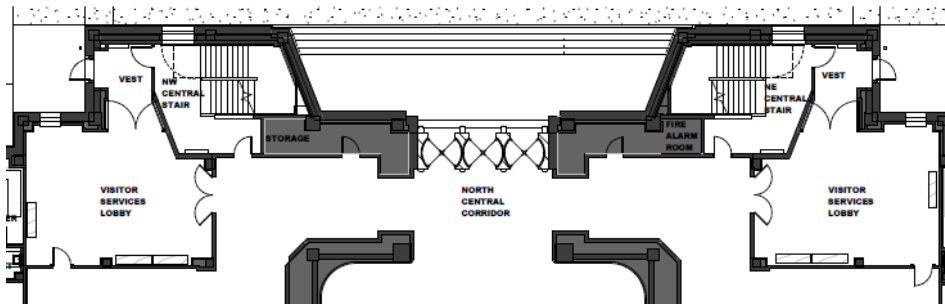

Priorities

Work should be sequenced to minimize disruption to the legislative calendar.

Existing design work from the Oregon State Capitol Renovation (OSCR) project should be utilized to its fullest extent.

Work performed should be complementary to any potential future seismic work.

Work should allow for ongoing occupancy of the Capitol while work is underway.

Timeline

Summer 2016

*Governor's fire detection
Wings elevators controls*

Fall 2016

*Exterior waterproofing (starts)
ADA door hardware
Rotunda plaster repairs
OSP, IS, Press, LRO moves
Camperdown Elm moves*

Summer 2017

*Exterior waterproofing (continues)
Vaults with mechanical, electrical
Treasurer, Gov Staff, LRO (perm) moves*

Fall 2017

*Mech/Elec/Plumbing work (continues)
North stair*

Spring 2018

South, East and West ADA entries

2017

2018

2019

long session

short session

long session

FY 16-17

FY 17-18

FY 18-19

Budget

<u>Biennium</u>	<u>Amount</u>	<u>Fund Source</u>
15-17	\$ 6,679,358	General Fund/LA
15-17	\$30,000,000	Bonds
17-19	\$13,320,642	Bonds
	<hr/> \$50,000,000	