



Notice of Work- Soil Bearing Test

To: Capitol Building

From: Oregon State Capitol Renovation (OSCR) Team

Date: December 10, 2014

The following OSCR project team members will be working in the Capitol:

- Several representatives from DBM Contractors, JE Dunn and Capitol Facility Services

Scheduled Date and Time of Work:

- Team members will begin preparing the materials staging areas in the garage the evening of December 12, 2014
- The testing will be performed Monday, December 15th, 2014 – Friday, January 9th, 2015
- Work will be done during night hours, from 5:00 p.m. – 8:00 a.m.

Location of work:

- Work will be performed in the Capitol Parking Garage and in the Southeast corner of the parking lot in front of the building.

**** Please see plans below for more detail ****

Work to be performed:

- Team members will be installing several micro piles in two locations within the Capitol Parking Garage and one micro pile in the front exterior parking lot.

Impacts:

- The team will be escorted by a Facility Services representative while the work is being conducted.
- All work will be performed during night hours, 5:00 p.m. – 8:00 a.m. to avoid any disruption.
- Contractor's materials and equipment will be tented off and enclosed in all work locations.
- Several parking spaces will be unavailable for the duration of this work. **Facility Services will be making contact with those who have parking spaces affected by this investigation, if they have not done so already.**
- The garage will remain open for through traffic.
- The front parking lot and bus unloading area will remain open and available for use.
- Parking spaces in the front lot that are impacted will be relocated to the Southwest corner of the lot.
- This work will create loud noise, but should not impact the daily work functions as the work is taking place at night.

900 Court Street NE | Room 354 | Salem, OR 97301

503.986.1190

<http://www.oregonlegislature.gov/renovation>

Purpose of work:

- This work is being done to determine the strength and load bearing capacity of the soil underneath the Capitol Building. This will provide valuable information regarding the amount of micro piles that will need to be installed to support the Capitol Building during the seismic upgrade and base isolator installation, if the project is approved to move forward into the Construction Phase.

It is our goal to gather the above information in the most discreet method possible. Should any questions or concerns arise in the process of the work being conducted, we welcome you to contact us in Room 354 at 503.986.1190.

Thank you,
Jessica Lacasella

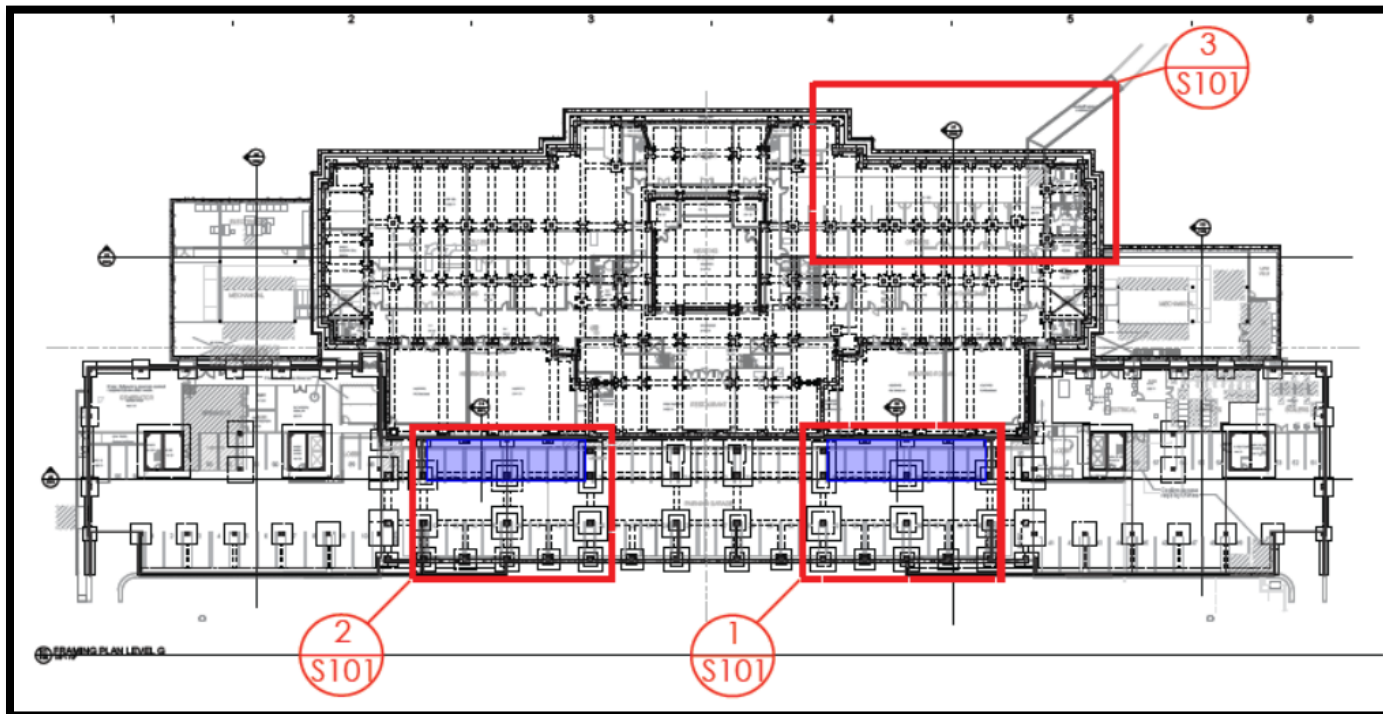

Capitol Parking Garage: The blue rectangular boxes designate the locations in which the test piles will be located.

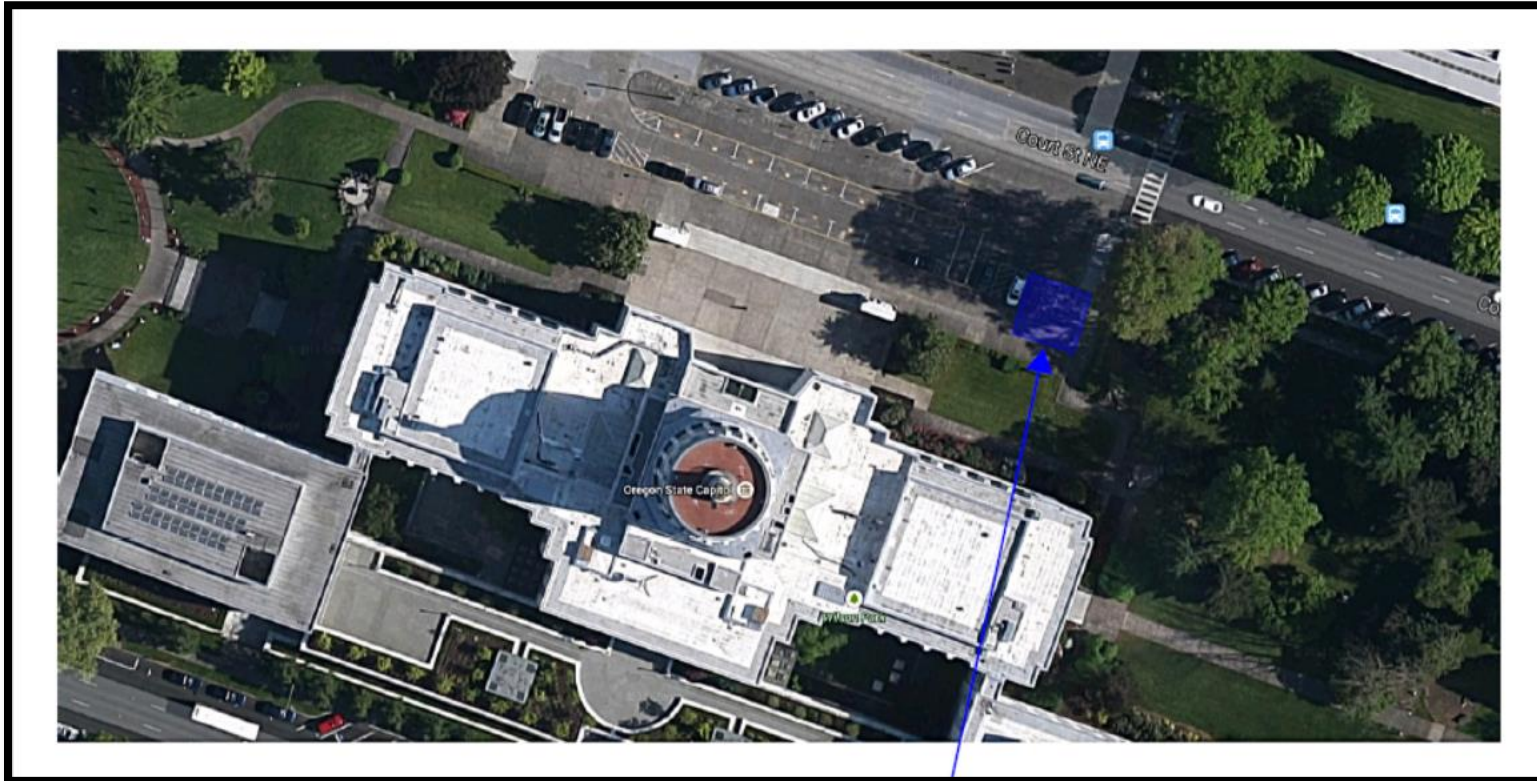

Front Parking Lot: The blue box designates the exterior testing location. This area will be blocked off with fencing called cattle guard to prevent access to the area by pedestrians. Some parking spaces will be disrupted by this investigation. However, they will be relocated to the other side of the lot. The sidewalk in this location will be impacted minimally and will remain open to pedestrian traffic.