



Notice of Work

To: Departments- Press Corp, Visitor Services and Committee Services

From: Oregon State Capitol Renovation (OSCR) Team

Date: March 14, 2014

The following OSCR project team members are requesting access to your office space:

- 2-3 Staff from the OSCR team, PBS Engineering and Environmental and Capitol Facility Services

Date and Time of Requested Access:

- Tuesday, March 18th, 2014
- The team will be conducting work in the locations designated on the map between 8:30 a.m. and 5:00 p.m. Each visit will take approximately 30 minutes.

Work to be performed:

- PBS will take small samples from walls and of the glue found under the carpet or floor tile. To obtain the glue sample from under the flooring, a small corner of the tile or carpet will be lifted. Upon obtaining the sample, the flooring will be put back in place. To obtain the samples from within the walls, the team member will use hand tools to cut a 2" x 2" section out of the wall in a discreet location. Upon retrieving the sample, the hole will be patched but not painted.

Impacts

- At times, there may be some sound generated from cutting into the wall with hand tools.

Specific Space Requested for Access:

- Please see the attached plan, outlining specific rooms and locations for testing.
- **The PBS team member will be escorted by a Capitol Facility Services representative to all offices visited after 5:00 p.m.**

Purpose of Work:

- The team is testing for possible lead and asbestos in these areas.

It is our goal to gather the above information in the most discreet method possible. If the requested date and time do not work well for your office or department, please let us know and we would be happy to reschedule for a later date at a more convenient time for you. Should any questions or concerns arise in the process of the work being conducted, we welcome you to contact us in Room 354 at 503.986.1190.

Thank you,

Jessica Lacasella

Project Communications Coordinator

P: 503.986.1190 | Email: jessica.lacasella@state.or.us

1 expose wall to CL of column

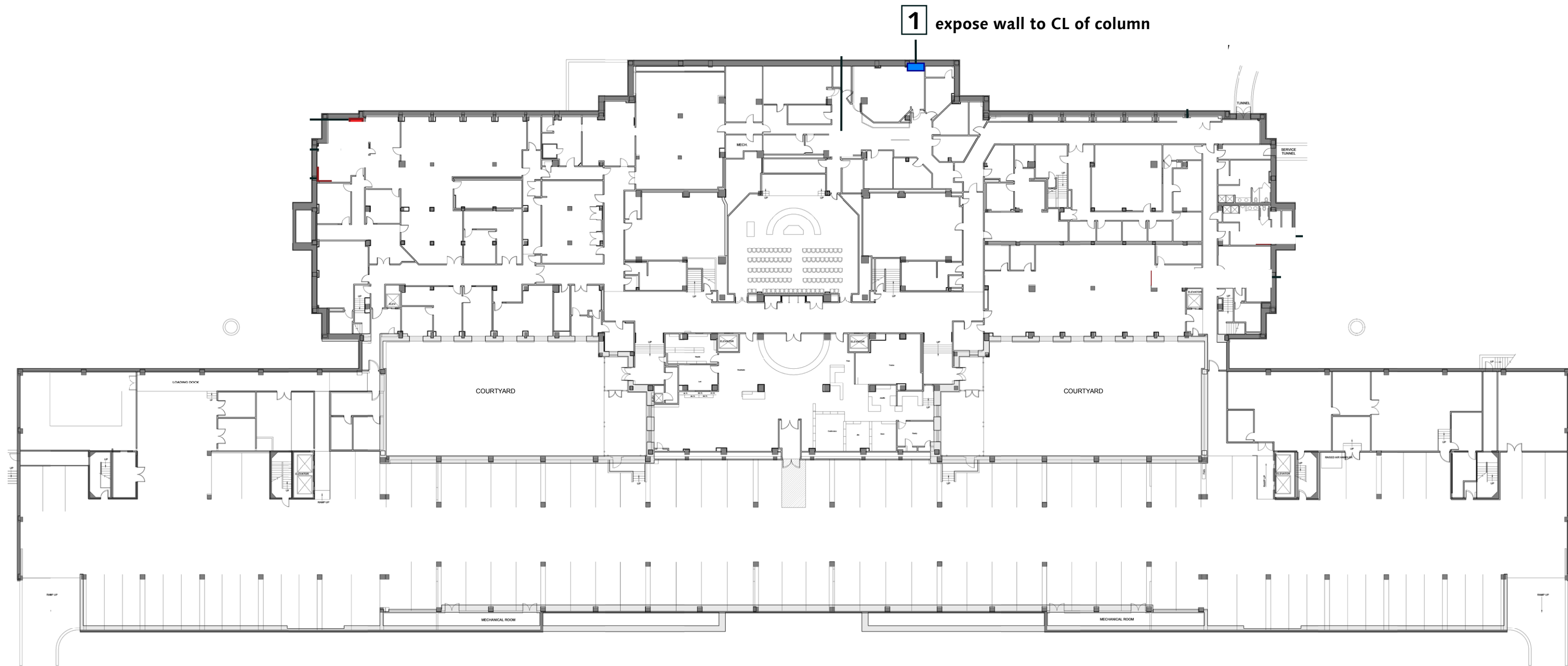

■ 1 - 3 Testing site locations

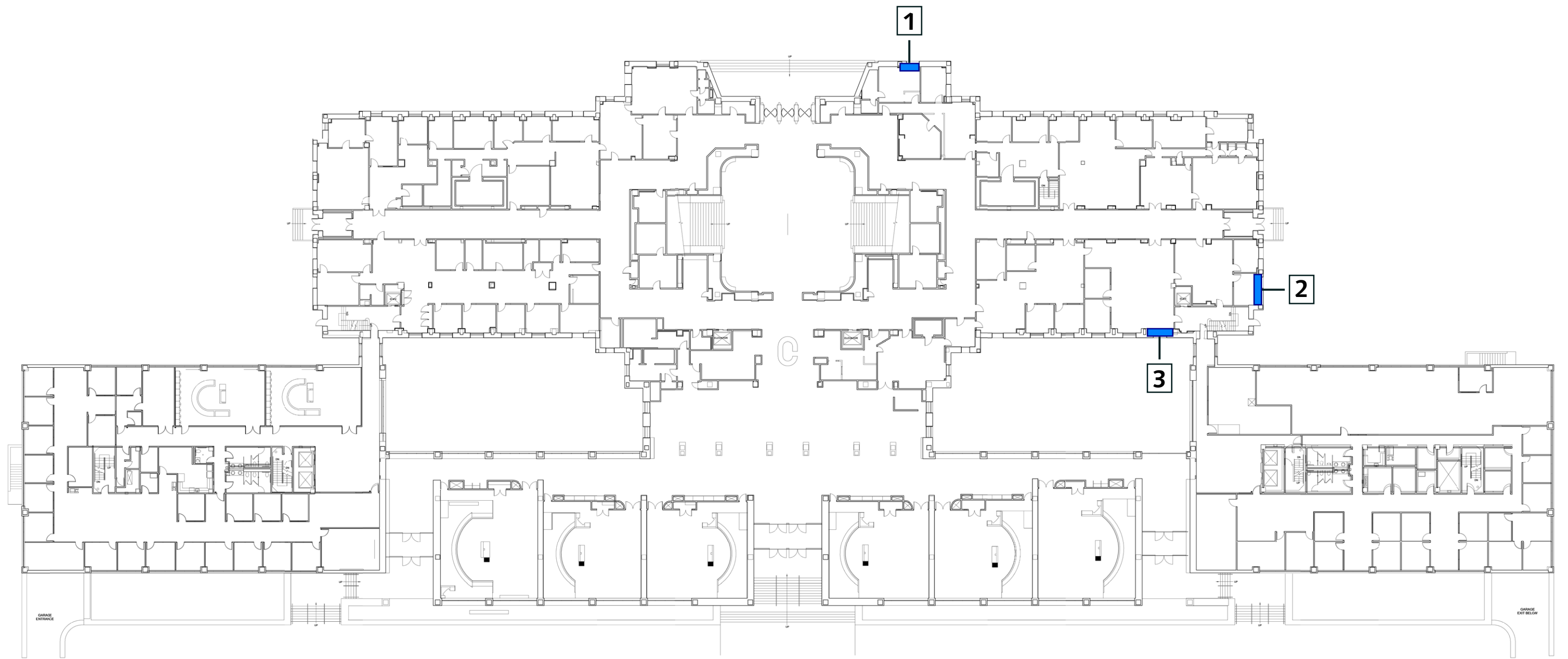

LEVEL 1

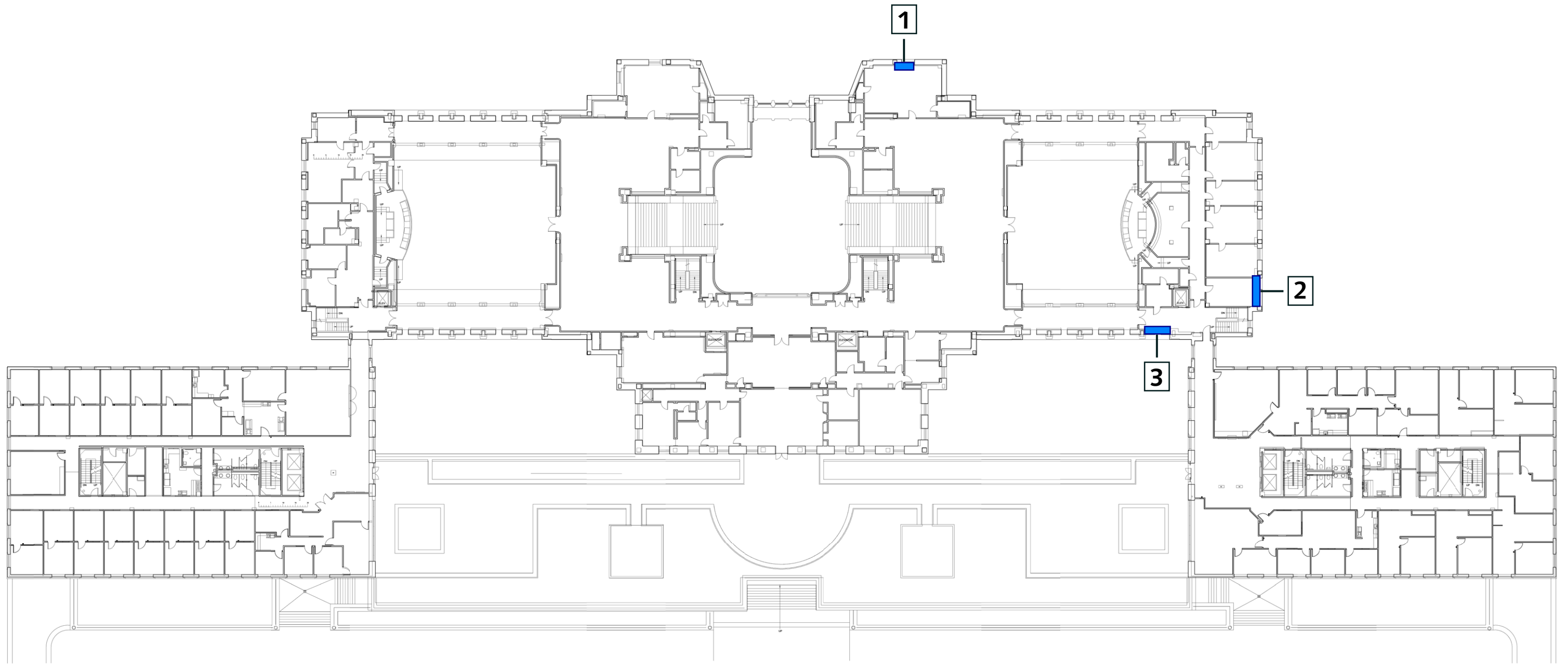

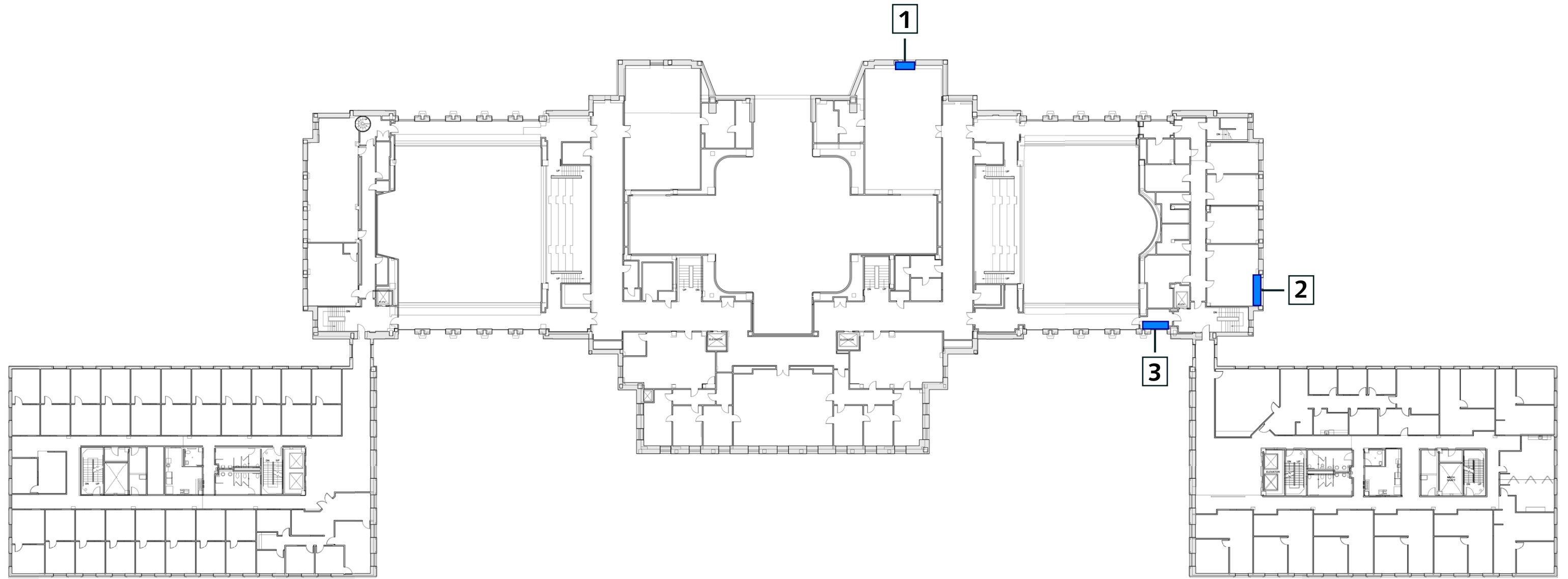

LEVEL 3

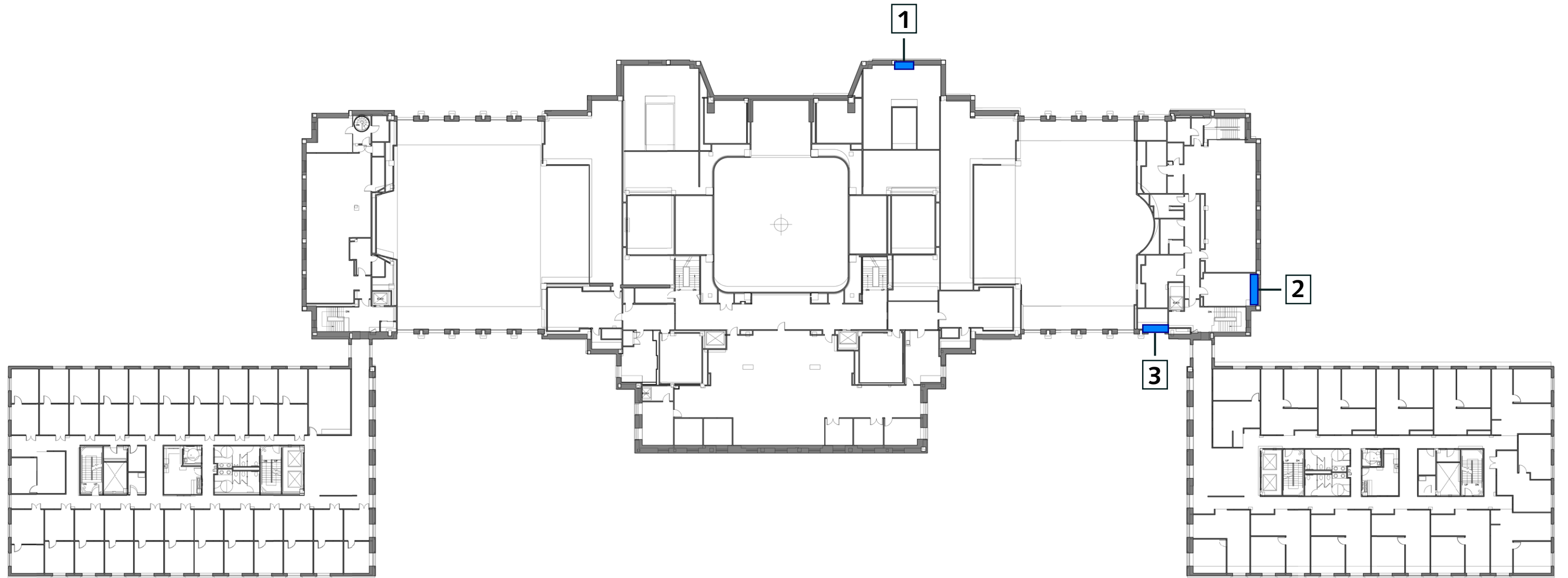

LEVEL 4