

## Notice of Work

To: Capitol Building

From: Oregon State Capitol Renovation (OSCR) Team

Date: April 30, 2014

---

The following OSCR project team members will be working throughout the building:

- Several representatives from PBS Engineering & Environmental, JE Dunn and Capitol Facility Services.

Date and time of work:

- Work begins on Monday, May 5<sup>th</sup>, 2014 and will continue through Monday, June 9<sup>th</sup>, 2014.
- Work will be done in unoccupied spaces (i.e. vacant offices, hallways, mechanical rooms, etc.) between the hours of 8:00 a.m. and 5:00 p.m. daily.
- Work will be done in occupied spaces (i.e. offices) between the hours of 7:00 p.m. and 6:00 a.m. daily.
- A Capitol Facility Services representative will accompany the PBS team while they are performing their work at night and while in occupied offices.

Location of work:

- Monday, May 5<sup>th</sup>- Friday, May 16<sup>th</sup>, 2014
  - Every room on the Ground Floor
- Monday, May 19<sup>th</sup>- Friday, May 23<sup>rd</sup>, 2014:
  - Every room on the 1<sup>st</sup> floor of the 1938 building and wings
- Monday, May 26<sup>th</sup> – Friday, May 30<sup>th</sup>, 2014:
  - Every room on the 3<sup>rd</sup> and 4<sup>th</sup> floors of the 1938 building
- Monday, June 2<sup>nd</sup> – Monday, June 9<sup>th</sup>:
  - Every room on the 2<sup>nd</sup> floor of the 1938 building

**\*\* Please see the plan below for additional information\*\***

Work to be performed:

- Team members will be surveying for hazardous building materials including asbestos, lead-based paint, polychlorinated biphenyl (PCB) containing light ballasts, mercury-containing switches, light tubes, etc.
- Physical samples will be collected from materials suspected of containing asbestos and lead. **Samples will only be collected while spaces are unoccupied.** If necessary, the samples will take place at night when rooms are unoccupied to avoid disruptions to daily work.

**Impacts:**

- **This work is not anticipated to impact building systems or components. The team will employ appropriate protective measures during survey activities. The survey methods and impacts to building materials are not anticipated to present a hazard to employees within the building,.**
- Lead paint test samples require the team to cut a square approximately 2 inches wide and tall in walls.
- Samples will be taken in discreet locations whenever possible to minimize visual impacts.
- The team will be using a number of hand tools, razor knives, chisels, etc. to obtain sample. Use of these tools should minimize any sound impacts. However, there may be some *rare* instances where they need to use small power tools. In this instance, the power tools would be running for approximately 1-2 minutes.
- JE Dunn team members will patch any holes the same day/ night the sample was taken from that location.

**Purpose of work:**

- This work is being done to determine the existence and locations of hazardous materials within the building.

It is our goal to gather the above information in the most discreet method possible. Should any questions or concerns arise in the process of the work being conducted, we welcome you to contact us in Room 354 at 503.986.1190.

Thank you,

Jessica Lacasella

Project Communications Coordinator

P: 503.986.1190 | Email: [jessica.lacasella@state.or.us](mailto:jessica.lacasella@state.or.us)

L:\Projects\23000\23400-23499\23453\_ORStateCapitalSeismic\23453.001\_LegAdmORStateCap\DWG\23453.001\_FIGURE 1\_PHASING.dwg Apr 21, 2014 01:43pm jmb

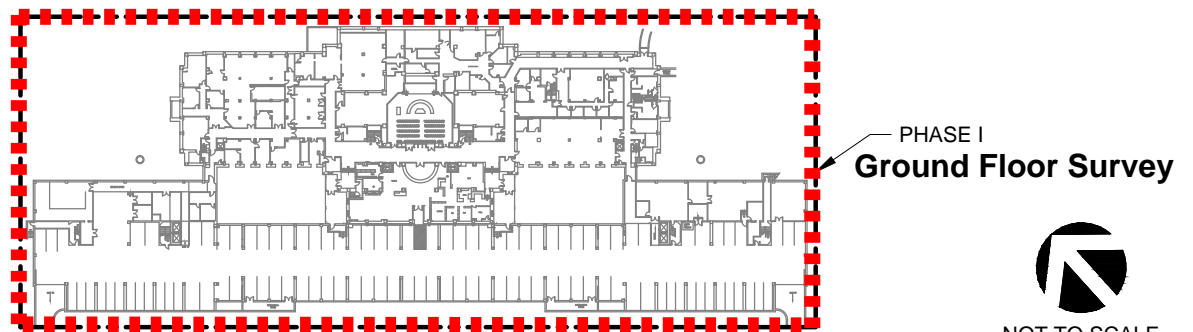
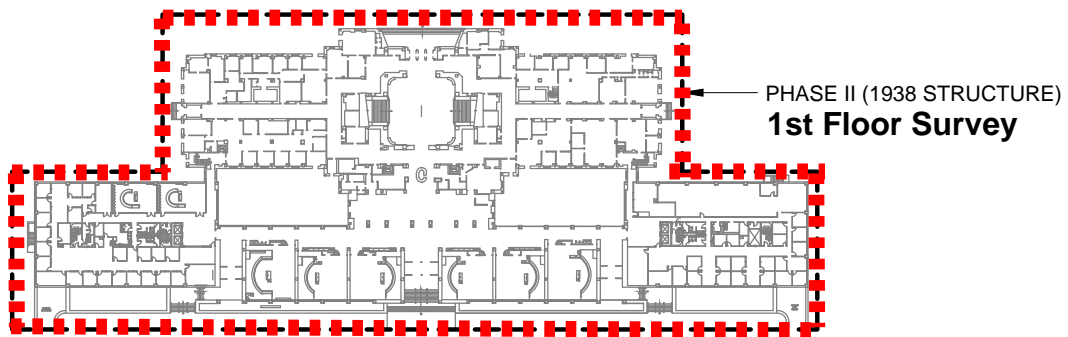
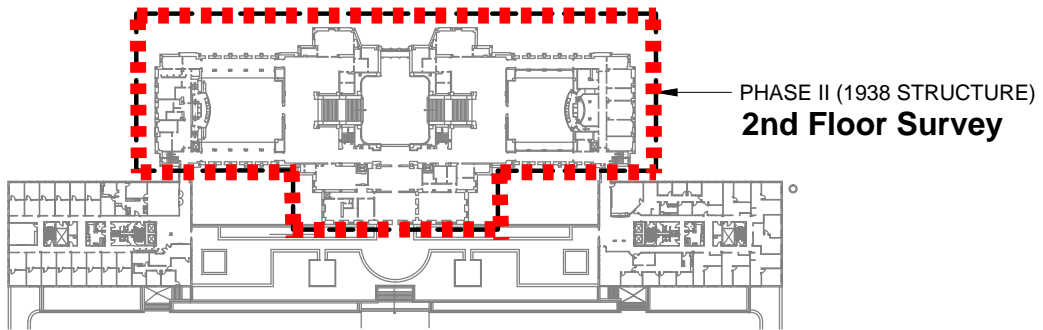
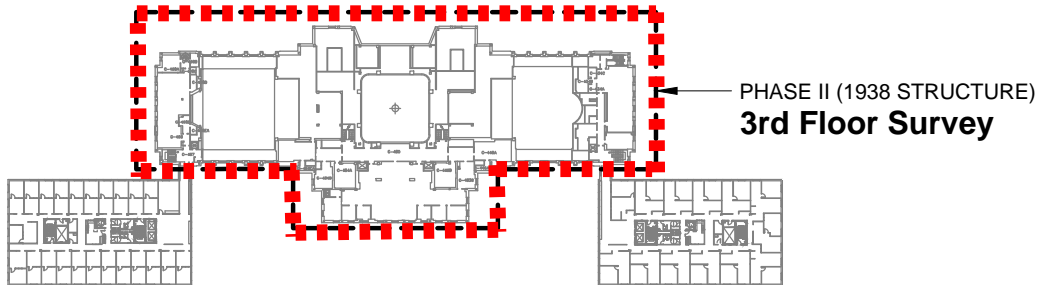
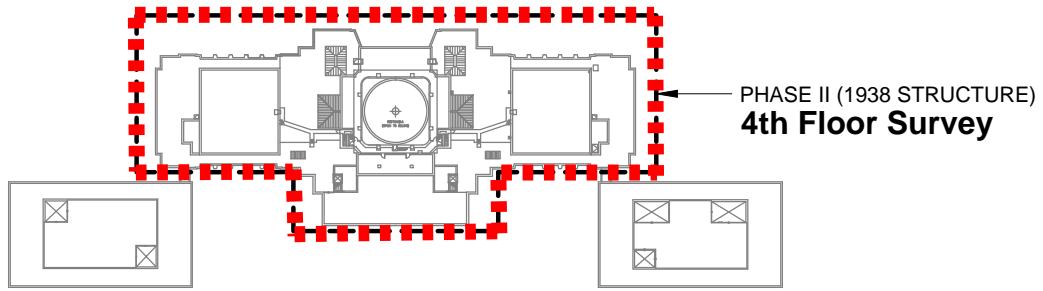

PREPARED FOR: LEGISLATIVE ADMINISTRATION



PROJECT #  
23453.001

DATE  
APRIL 2014

**OREGON STATE CAPITOL BUILDING**  
RENOVATION PROJECT  
900 COURT STREET NE  
SALEM, OREGON

FIGURE  
**1**